

EXHIBITION PROSPECTUS

IEEE ICC 2010



IMPORTANT DATES

Conference dates: **23-27 May 2010**

EXHIBITION BOOKINGS

- Open: 19 August 2009
- Close: 31 March 2010

GENERAL INFO

The IEEE Communications Society invites the world's leading researchers and engineers from academia, industry and government to exchange their ideas at the IEEE ICC 2010 conference in Cape Town, South Africa in May 2010. This flagship International Communications Conference (ICC) will be hosted at the CTICC. This will be the first time that ICC will take place in Africa. With Cape Town being voted one of the most beautiful cities in the world, this promises to be an exceptional world-class conference.

Besides the opportunity for high-quality discussions about the most recent technologies and business applications, the IEEE ICC 2010 offers an extraordinary visibility with the powerful, international audience attending the conference. The IEEE ICC attracts all major role players in communications, i.e., leading customers, operators, vendors, researchers, investors and press. It has a long track record with an increasingly powerful, loyal audience and is considered as a "major communications event" since 1965. The conference theme "Communications: Accelerating Growth and Development" aims to focus on the role that Communications in the rapid development of communication in Africa.

The character of the event as places where important ideas are exchanged, recent developments are discussed and current products are presented is evident and continually reinforced throughout the event.

To improve the conference's diversity, the ICC 2010 provides an integrated exhibition area close to technical sessions, coffee areas and poster areas to ensure continuous exposure to delegates and potential clients. This is an excellent opportunity to show case your company and get in touch with the best and most ambitious talents and opportunities in industry and academia.

CONFERENCE VENUE

The conference will take place at the Cape Town International Convention Centre (CTICC), Convention Square, 1 Lower Long Street, Cape Town.

Centrally located in the city, the CTICC is an attractive building, diffusing daylight. The complex is disabled-friendly, with international standard wheel-chair access, designated drop-off points and parking bays, toilets for the physically challenged and elevators with Braille inscription.

For information on the CTICC, please visit www.cticc.co.za

THE EXHIBITION

The ICC 2010 provides an integrated exhibition area close to technical sessions, coffee areas and poster areas to ensure continuous exposure to delegates and potential clients. This is an excellent opportunity for both commercial and non-commercial organisations to showcase their products and services to the communication professionals of the world. This is also the ideal occasion to get in touch with the best and most ambitious talents and opportunities in industry and academia. With 200 square meters of prime exhibition space and more than 1,000 delegates expected, your organisation cannot afford to miss the chance to reach so many key players in the communication community.

The exhibition floor is situated in the Clivia conservatory, Jasminium restaurant and conservatory and Strelitzia restaurant area, in the Cape Town International Convention Centre. To ensure high volumes of traffic and the highest visibility, it is next to the poster exhibition. The area will also include a catering area ensuring that it remains the hub for all delegates who want to stay connected.

APPLYING FOR EXHIBITION SPACE

Exhibition applications should be made by completing an APPLICATION FORM (please download the form from the IEEE ICC 2010 website (<http://www.ieee-icc.org/2010/>))

The deadline for exhibition applications is 31 January 2010. If capacity is reached, exhibition applications will be closed earlier than the planned date.

STAND AND FLOOR SPACE ALLOCATION

Stand and floor spaces are assigned on a "first come, first served" basis, according to the date applications are received. To guarantee favourable positioning, reserve exhibit space early!

The application deadline is 31 January 2010. Only fully completed exhibition application form orders will be accepted. The application form order will only be confirmed upon receipt of payment in full in accordance with the general terms and conditions. The organiser reserves the right to accept or reject applications and assign spaces.

Whilst the organiser shall take all reasonable steps to ensure that the location of the booth within the exhibition area is as agreed in this agreement, the organiser shall have the right to relocate the booth at their discretion and the organiser shall not be held liable for any loss or damage, of whatsoever cause and howsoever arising in the event of a relocation.

The organiser reserves the right in its sole and absolute discretion, should the venue become unuseable, or the dates become unsuitable for any reason, to relocate to a new venue or re-schedule the dates and the exhibitor agrees to be bound to this relocation and/or rescheduling of dates and the organiser shall not be held liable for any loss or damage, of whatsoever cause and howsoever arising due to these changes in venue and/or dates.

EXHIBITOR BADGES

Exhibitor registration includes entry to the exhibition area only. Entry to the conference sessions and the closing session is not included. A conference bag and other conference materials are also not included.

Each exhibitor will receive three exhibitor badges.

SET UP TIME

Saturday 22 May 2010: 14:00- 17:00
Sunday 23 May 2010: 9:00-13:00

All exhibit installation must be completed by 13:00 on Sunday, May 23. On Sunday the exhibit hall will be cleared at 14:00. Exhibitors that have not completed exhibit installation by 14:00 on Sunday will not be allowed to complete the installation of the exhibit.

EXHIBITION TIMES

Sun 23 May 2010: 18:00-20:00
Mon 24 May 2010: 09:00-17:30
Tues 25 May 2010: 09:00-17:30
Wed 26 May 2010: 09:00-17:30
Thurs 27 May 2010: 09:00-17:00

STRIKE TIMES

Thurs 27 May 2010: 18:00-22:00

No dismantling is permitted prior to 18:00.

COSTS

Exhibition space costs are as follows:

Floor space only R17000 (3m x 3m) or R19000 (6m x 3m)

Shell Scheme R2000 (3m x 3m) or R4000 (6m x 3m)

Use the Application Form to book your requirements.

The Exhibit Space/Stand display includes:

- 3m x 3m or 3m x 6m exhibition space only
- Optional Stand shell scheme framework and wall panels including:
 - Fascia panel with company name and stand number
 - 2 light fixtures and 1 electrical plug point,

The exhibit fee includes:

- Welcome Reception held in the Exhibition Hall
- Three Exhibitor badges
- Exhibitor's Service Manual
- Delegate Lunches and Teas

The exhibit fee excludes:

- Booth furniture
- Booth cleaning
- Attendance of sessions
- Attendance of award function



EXAMPLE OF 3X3 EXHIBITION SHELL

The exhibition area is tiled and therefore no carpeting is allowed.

FLOOR PLAN

See Addendum A - attached

FIRST AID AND MEDICAL SERVICES

The CTICC refers delegates in need of medical attention to Medi-Travel International (MTI). Situated at the Clock Tower Precinct at the V&A Waterfront in Cape Town, MTI is a medical facility catering for both local and international visitors and travelers. The MTI centre offers a casualty service for medical emergencies, a health care service and a registered travel clinic service.

The CTICC also has an on-site nurse on duty weekdays between 08:00 and 17:00.

CONTACT INFORMATION: EXHIBITION ORGANISER

IMFUNZELELO

CONTACT PERSON: Zelda Coetzee
OFFICE TEL: +27 (0)21 762 1442
CELL/MOBILE: +27 (0) 846575476
EMAIL: zelda@imfunzelelo.co.za
WEB: <http://www.ieee-icc.org/2010/>

CONTACT INFORMATION OF PREFERRED SUPPLIERS

Oasys is the appointed agent for: stand building, furniture, electrical, stand designs/builder.

Contact:

Beulah Henning

TEL: +27 (0) 21 526-3200
FAX: +27 (0) 21 552-1841
WEB: <http://www.oasys.co.za/>

Exhibition Freighting is the appointed agent for freight forwarding/storage.

Contact:

Jacqui Nel

TEL: +27 (0) 21 552-7248
FAX: +27 (0) 21 552-2349
EMAIL: EF-GSM@IAFRICA.COM

TERMS AND CONDITIONS

The exhibitor must pay with application 33% of the total fee for exhibit space, second deposit 33% is due January 31, 2010 and *the balance due by March 15, 2010*. Applications received after March 1, 2010, must be submitted with full payment. Incomplete applications, unapproved exhibitor's applications, and applications received without deposits will not be processed. This application will not be valid or binding until approved and signed by an authorized IEEE representative, and may be cancelled at any time by IEEE with written notice.

RULES AND REGULATIONS

Cancellation /booth reduction

Organisations participating in the exhibition may cancel this agreement at any time by written notice to the Exhibits Management at Imfunzelelo. The following schedule will be used when acknowledging the cancellation and/or booth reductions: Booth reductions and/or cancellations received on or before November 1, 2009, will receive a refund of all fees paid less a 10% processing fee of total booth space reserved. Cancellations or booth reductions received from November 1, 2009, to February 1, 2010, provided full payment has been received, will receive a refund of 50% of the total amount due for booth space. No refunds will be made for cancellations or booth reductions received after 15 February 2010.

SECURITY

The organisers shall provide guard service throughout the hours of installation, show and dismantlement period, and exercise reasonable care for the protection of the exhibitors' materials and display. Beyond this, the organisers, the show facility, or any officer or staff member or vendor thereof will not be responsible for the safety of the property or the exhibitor, his agents or employees, from theft, damage by fire, accident, or any other cause. Exhibitor is required to secure sufficient insurance coverage for all booth contents.

Optional security screens are also available for booths with shell schemes; see expo screen hire form.

ARRANGEMENT OF EXHIBITS

In the area 3 meters forward from the rear background of each booth, display material may be placed up to a height not exceeding 3 meters from the building floor. Exhibits not conforming to these specifications, or which in design, operation, or otherwise, are objectionable in the opinion of the organisers will be prohibited. No solid construction will be permitted.

The organiser at all times will have free and undisturbed access to the booth during build up/ break down and throughout the duration of the event.

During the course of the exhibition the exhibitor shall maintain the shell scheme in good order and condition and shall follow all of the organiser's instructions from time to time with regard to the use and care thereof.

The exhibitor shall keep the booth open and adequately staffed during exhibition times.

Exhibitors that promote, distribute, or display products/services that are not approved by IEEE, contrary to the IEEE's purpose for industrial exhibits or in the IEEE's opinion are not conducive or related to communication will be asked to remove the material or shut down immediately.

LIABILITY

The Exhibitor hereby agrees to and does indemnify, hold harmless and defend IEEE ICC organisers from and against any and all liability, responsibility, loss, damage, cost, or expense of any kind whatsoever (including but not limited to cost, interest, and attorney's fees) which IEEE ICC may incur, suffer, be put to, pay or be required to pay, incident to or arising directly or indirectly from any intentional or negligent act or omission by Exhibitor or any of its employees, servants, or agents. The Exhibitor further agrees that the organisers, and its respective agents and employees shall not be responsible in any way for 1) damage, loss or destruction of any property of Exhibitor or 2) injury to exhibitor or its representatives, agents, employees, licensees or invitees. Under no circumstances will children be allowed in the exhibit hall during installation or dismantle.

USE OF BOOTH AND NO CESSION OR ASSIGNMENT

The exhibitor shall not use any form of visual or vocal apparatus on the booth, which causes an annoyance or nuisance to other exhibitors, the organiser or the CTICC, or demonstrate any product which produces excessive noise.

The exhibitor shall only be entitled to distribute literature and printed matter from their booth and shall not be entitled to distribute same anywhere else at the exhibition without the organiser's written consent.

The exhibitor shall not be entitled to cede, assign, transfer, make over, sublet, subcontract, delegate or alienate any of its rights or obligations in terms of this agreement without the organiser's written consent.

ADDENDUM A - FLOORPLAN

HALL 2

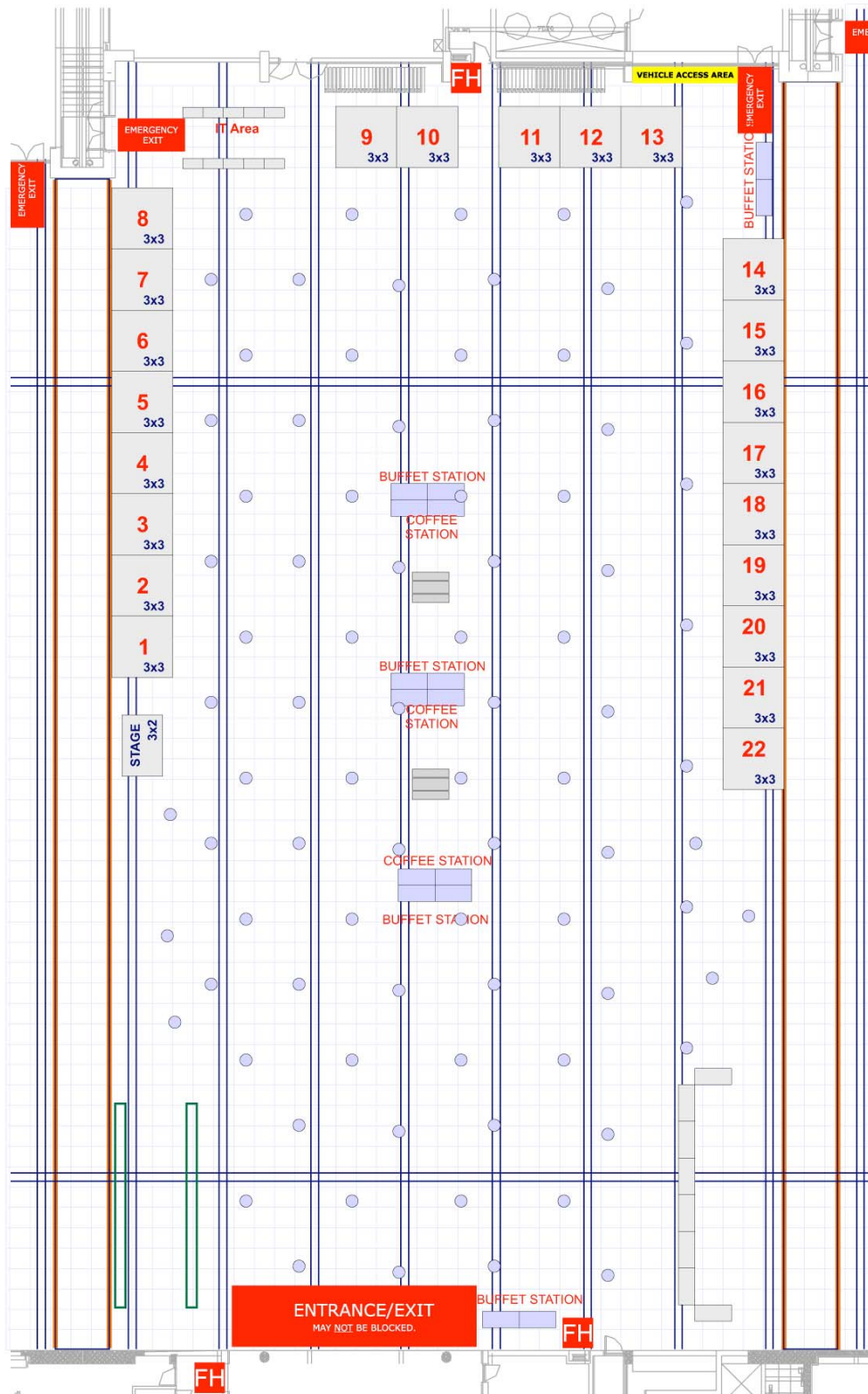

EXHIBITION APPLICATION & CONTRACT
IEEE ICC 2010 conference
Cape Town International Convention Centre – Cape Town, South Africa
May 23 - 27, 2010



PLEASE PRINT OR TYPE

Company Details

Company Name (To be listed in all IEEE Materials) _____

Contact Name (For all correspondence) _____

Mailing Address _____

City _____ State _____

Zip Code _____ Country _____

Telephone _____ Fax _____

Email _____

Exhibition Space Required			
Scheme	Price per Scheme	Quantity	ZAR (VAT EXCL)
Booth 3m x 3m (Floor space only)	R17000.00		
Booth 6m x 3m (Floor space only)	R34000.00		
Booth 3m x 3m (With Shell Scheme)	R19000.00		
Booth 6m x 3m (With Shell Scheme)	R38000.00		
Total Remittance			

Booth(s) Request: (Please indicate booth number choices in order of preference.)

1st _____ 2nd _____ 3rd _____ 4th _____

Agreement

I have read the information contained in the IEEE's Exhibitor Prospectus, and do hereby agree to abide by all requirements set forth in the Exhibitor Prospectus and any correspondence from IEEE or its agent(s)/vendors, that are reasonable and relative to the Congress.

Authorized exhibitor representative signature

Date

PLEASE SEND YOUR COMPLETED APPLICATION FORM TO zelda@imfunzelelo.co.za. ONCE YOUR APPLICATION HAS BEEN APPROVED WE WILL SEND YOU A CONFIRMATION LETTER AND INVOICE.

For further information, please contact

IEEE ICC 2010 Exhibition Manager
 c/oZelda Coetzee
 Imfunzelelo
 Tel: +27 (0)21 7621442 or Mobile: +27 (0)84 657 5476
 Email: Zelda@imfunzelelo.co.za

AUDIO VISION HIRE:



Company Name: _____
 Stand Number/s: _____
 Contact Person: _____
 Postal Address: _____
 Telephone Number: _____ Fax Number: _____
 Email Address: _____
 VAT# (SA Residents): _____

DEADLINE DATE: 28 April 2010

Enquiries: Beulah Henning
beulah@oasysexpo.com
Cell +27 (0) 83 215 8700

Please return forms to:

Tel: +27 (0)21 526 3200
Fax: +27 (0)21 552 1841

Services: services@oasysexpo.com

SEE OUR WEBSITE FOR IMAGES OF THE ITEMS: www.oasysexhibitions.co.za

OASYS EXHIBITIONS – PRO FORMA INVOICE

VAT REGISTRATION NO: 4610214399

PLASMA SCREENS

SIZE	DESCRIPTION	ACTUAL SIZE	QTY	PRICE EXCL. VAT	TOTAL
42"	PLASMA SCREEN	1020mm X 605mm X 95mm		1 550.00 (per day)	
50"	PLASMA SCREEN	1210 X 724 X 95		2 020.00 (per day)	
65"	PLASMA SCREEN	1554 X 925 X 95		2 780.00 (per day)	

LCD MONITORS (HD READY)

SIZE	DESCRIPTION	ACTUAL SIZE	QTY	PRICE EXCL. VAT	TOTAL
19"	LCD MONITOR			210.00 (per day)	
20"	LCD MONITOR			255.00 (per day)	
32"	LCD MONITOR			760.00 (per day)	

LCD MONITORS (FULL HD)

SIZE	DESCRIPTION	ACTUAL SIZE	QTY	PRICE EXCL. VAT	TOTAL
40"	LCD MONITOR			1 260.00 (per day)	
46"	LCD MONITOR			1 690.00 (per day)	
52"	LCD MONITOR			2 020.00 (per day)	
65"	LCD MONITOR			2 780.00 (per day)	

SEAMLESS PLASMA WALL

SIZE	DESCRIPTION	ACTUAL SIZE	QTY	PRICE EXCL. VAT	TOTAL
2 X 2	SEAMLESS PLASMA WALL	N/A		5 915.00 (per day)	
3 X 3	SEAMLESS PLASMA WALL	N/A		13 525.00 (per day)	
4 X 4	SEAMLESS PLASMA WALL	N/A		On request (per day)	
5 X 5	SEAMLESS PLASMA WALL	N/A		On request (per day)	

ACCESSORIES

SIZE	DESCRIPTION	ACTUAL SIZE	QTY	PRICE EXCL. VAT	TOTAL
N/A	DVD PLAYER	N/A		185.00 (per day)	

PLEASE NOTE THAT PRICES EXCLUDE 14% V.A.T. (SA RESIDENTS ONLY)

PAYMENT:

- Payment is required in full, before delivery will take place.
 - Payment can be done up to two months prior to the exhibition, should you so desire.
 - Once you have placed your order and completed the client information form and signed quote and paid in full, Oasys Exhibitions will arrange and forward you a tax invoice
 - Payment can be done via credit card, bank transfer, cash or bank guaranteed cheque.
 - Our bank account details are as follows:
Bank: Standard Bank - Southdale
Account Name: Oasys Innovations (Pty) Ltd t/a Oasys Exhibitions CT
Account Number: 0000002787504
Branch Code: 006405
Swift: SBZAZAJJ
- Interest on all overdue accounts will be levied at the rate of 2% above the Prime Overdraft Lending Rate of Standard Bank.

CONDITIONS OF HIRE & SUPPLY:

1. Orders subject to stock availability.
2. Items hired, remain the property of Oasys Exhibitions (Pty) Ltd.
3. NO GOODS WILL BE DELIVERED, UNLESS PAID FOR IN FULL WITH ORDER.
4. **Late orders received after the cut off time will be subject to a surcharge of 50%.**
5. Goods damaged, will be charged to the relevant exhibitor.

PLEASE KEEP A COPY FOR YOUR RECORDS

FASCIA NAME ON STAND:



Company Name: _____
Stand Number/s: _____
Contact Person: _____
Postal Address: _____

Telephone Number: _____ Fax Number: _____
Email Address: _____
VAT# (SA Residents): _____

DEADLINE DATE: 28 April 2010

Enquiries: Beulah Henning
beulah@oasysexpo.com
Cell +27 (0) 83 215 8700

Please return forms to:

Tel: +27 (0)21 526 3200
Fax: +27 (0)21 552 1841
Services: services@oasysexpo.com

SEE OUR WEBSITE FOR IMAGES OF THE ITEMS: www.oasysexhibitions.co.za

OASYS EXHIBITIONS – PRO FORMA INVOICE

VAT REGISTRATION NO: 4610214399

1. FASCIAS

- We do require a fascia board
- We do require a fascia board, but do not require a fascia name (i.e. blank fascia board)
- We do not require a fascia board

NOTE: Removal of fascias on site will incur at extra cost to the exhibitor concerned. It also may NOT be possible due to the fact that all the electrics run along the top of the Shell Scheme.

STAND PLAN DIAGRAM:



Company Name: _____
Stand Number/s: _____
Contact Person: _____
Postal Address: _____

Telephone Number: _____ Fax Number: _____
Email Address: _____
VAT# (SA Residents): _____

DEADLINE DATE: 28 April 2010

Enquiries: Beulah Henning

Beulah@oasysexpo.com

Cell +27 (0) 83 215 8700

Please return forms to:

Tel: +27 (0)21 526 3200

Fax: +27 (0)21 552 1841

Services: services@oasysexpo.com

SEE OUR WEBSITE FOR IMAGES OF THE ITEMS: www.oasysexhibitions.co.za

OASYS EXHIBITIONS – PRO FORMA INVOICE

VAT REGISTRATION NO: 4610214399

TO ENSURE CORRECT PLANNING FOR THE SHOW, THE INSTALLATION OF YOUR SERVICE REQUIREMENTS AND THAT STANDS ARE OF A SUITABLE STANDARD, THIS FORM MUST BE COMPLETED AND RETURNED.

On the grid provided please indicate the position of the services ordered.

1. Type of electrical connections i.e. plug points **X**, spot lights **⊕**/connection for own lights.
2. Position of furniture and equipment used.
3. Any other information not specified above

Stand of size ordered: _____m x _____m **SCALE: One block =** _____

PLEASE NOTE: Should this form not be completed and returned, services requested will be placed at the discretion of the contractors and any changes made on site will be subject to an extra charge and may not be able to be affected. Please check that the relevant forms have been completed and that payment has been made.

PLEASE KEEP A COPY FOR YOUR RECORDS

ELECTRICAL HIRE:



Company Name: _____
Stand Number/s: _____
Contact Person: _____
Postal Address: _____

Telephone Number: _____ Fax Number: _____
Email Address: _____
VAT# (SA Residents): _____

DEADLINE DATE: 28 April 2010

Enquiries: Beulah Henning

beulah@oasysexpo.com

Cell +27 (0) 83 215 8700

Please return forms to:

Tel: +27 (0)21 526 3200

Fax: +27 (0)21 552 1841

Services: services@oasysexpo.com

SEE OUR WEBSITE FOR IMAGES OF THE ITEMS: www.oasysexhibitions.co.za

OASYS EXHIBITIONS – PRO FORMA INVOICE

VAT REGISTRATION NO: 4610214399

DESCRIPTION	QTY	PRICE EXCL. VAT	TOTAL
Three Phase Power Connection Only (Pls produce a C.O.C)		R618.00	
30 Amp Single Phase Distribution Board (includes 3 points)		R972.00	
30 Amp Three Phase Distribution Board		R1 142.00	
60 Amp Three Phase Distribution Board		R3 527.00	
125 Amp Three Phase Distribution Board		R4 710.00	
160 Amp Three Phase Distribution Board		R5 624.00	
Outdoor 30 Amp Three Phase Distribution Board		R1 379.00	
25 Amp Outlet for 30 Amp Three Phase Distribution Board		R252.00	
15 Amp Plug Point* - see note NB		R164.00	
2,4m Two Lamp Fluorescent		R286.00	
1,5 m Two Lamp Fluorescent		R230.00	
0,9m / 1,2m Two lamp Fluorescent		R188.00	
50 Watt Longarm Spotlight		R199.00	
50 Watt Downlight		R199.00	
150 Watt Spotlight		R164.00	
500 Watt Quartz Fitting		R207.00	
1500 Watt Quartz Fitting		R317.00	
150 Watt Metal Halide		R761.00	
Exhibitor's Connection		R118.00	
SUB TOTAL			R

PLEASE NOTE THAT PRICES EXCLUDE V.A.T.

- **NB: If you have not opted for a 'package' stand, and do require electrics; plug points need to be ordered along with a power source (DB) for power supply. We suggest minimally a 30 Amp Single Phase DB be ordered. This DB includes three plug points, so additional points can be ordered should you require more. This recommendation is based on usage of light currency only. For heavy current usage, a larger power supply unit may be required. Please feel free to contact Oasys for assistance, on +27 (0)21 526 3200.**

PAYMENT:

- Payment is required in full, before delivery will take place.
- Payment can be done up to two months prior to the exhibition, should you so desire.
- Once you have placed your order and completed the client information form and signed quote and paid in full, Oasys Exhibitions will arrange and forward you a tax invoice
- Payment can be done via credit card, bank transfer, cash or bank guaranteed cheque.
- Our bank account details are as follows:

Bank: Standard Bank - Southdale
 Account Name: Oasys Innovations (Pty) Ltd t/a Oasys Exhibitions CT
 Account Number: 0000002787504
 Branch Code: 006405
 Swift: SBZAJJ

Interest on all overdue accounts will be levied at the rate of 2% above the Prime Overdraft Lending Rate of Standard Bank.

CONDITIONS OF HIRE & SUPPLY:

- Orders subject to stock availability.
- Items hired, remain the property of Oasys Exhibitions (Pty) Ltd.
- NO GOODS WILL BE DELIVERED, UNLESS PAID FOR IN FULL WITH ORDER.**
- Late orders received after the cut off time will be subject to a surcharge of 50%.**
- Goods damaged, will be charged to the relevant exhibitor.

PLEASE KEEP A COPY FOR YOUR RECORDS

EXPO SCREENS HIRE:



Company Name: _____

Stand Number/s: _____

Contact Person: _____

Postal Address: _____

Telephone Number: _____ Fax Number: _____

Email Address: _____

VAT# (SA Residents): _____

DEADLINE DATE: 28 April 2010

Enquiries: Beulah Henning

beulah@oasysexpo.com

Cell +27 (0) 83 215 8700

Please return forms to:

Tel: +27 (0)21 526 3200

Fax: +27 (0)21 552 184

Services: services@oasysexpo.com

SEE OUR WEBSITE FOR IMAGES OF THE ITEMS: www.oasysexhibitions.co.za

OASYS EXHIBITIONS – PRO FORMA INVOICE

VAT REGISTRATION NO: 4610214399

We Hire the following Expo Screens Services

QTY	OPENINGS OF STANDS	COST	TOTAL
	2 OR 3 METRES WIDTH	@ R 961.85	
	4 METERS WIDTH	@ R 1 282.50	
	5 METERS WIDTH	@ R 1 603.15	
	ALARM (THIS IS ONLY AVAILABLE WHEN PLACING AN ORDER FOR EXPO SCREENS)	@ R 320.50	
	SUB TOTAL (EXCL VAT)		
	VAT @ 14%		
	TOTAL		

Prices are listed for the duration of the Expo. To confirm your order, please fax the completed form together with a payment confirmation. A tax invoice will be supplied after the exhibition, VAT REG. 4940143151

PLEASE NOTE THAT PRICES EXCLUDE V.A.T.

PAYMENT:

- Payment is required in full, before delivery will take place.
- Payment can be done up to two months prior to the exhibition, should you so desire.
- Once you have placed your order and completed the client information form and signed quote and paid in full, Oasys Exhibitions will arrange and forward you a tax invoice
- Payment can be done via credit card, bank transfer, cash or bank guaranteed cheque.
- Our bank account details are as follows:

Bank: Standard Bank - Southdale
 Account Name: Oasys Innovations (Pty) Ltd t/a Oasys Exhibitions CT
 Account Number: 0000002787504
 Branch Code: 006405
 Swift: SBZAJJ

Interest on all overdue accounts will be levied at the rate of 2% above the Prime Overdraft Lending Rate of Standard Bank.

CONDITIONS OF HIRE & SUPPLY:

11. Orders subject to stock availability.
12. Items hired, remain the property of Oasys Exhibitions (Pty) Ltd.
13. NO GOODS WILL BE DELIVERED, UNLESS PAID FOR IN FULL WITH ORDER.
14. Late orders received after the cut off time will be subject to a surcharge of 50%.
15. Goods damaged, will be charged to the relevant exhibitor.

PLEASE KEEP A COPY FOR YOUR RECORDS

FURNITURE HIRE:



Company Name: _____

Stand Number/s: _____

Contact Person: _____

Postal Address: _____

Telephone Number: _____ Fax Number: _____

Email Address: _____

VAT# (SA Residents): _____

DEADLINE DATE: 28 April 2010

Enquiries: Beulah Henning

beulah@oasysexpo.com

Cell +27 (0) 83 215 8700

Please return forms to:

Tel: +27 (0)21 526 3200

Fax: +27 (0)21 552 1841

Services: services@oasysexpo.com

SEE OUR WEBSITE FOR IMAGES OF THE ITEMS: www.oasysexhibitions.co.za

OASYS EXHIBITIONS – PRO FORMA INVOICE

VAT REGISTRATION NO: 4610214399

CODE	ITEM	DESCRIPTION	QTY	PRICE EXCL. VAT	TOTAL
H01	OFFICE CHAIR	BLACK		R180.00	
H02	CHROME & LEATHER CHAIR	BLACK		R265.00	
H03	BREEZE CHAIR	BLACK		R285.00	
H04	BLACK & CHROME PADDED CHAIR			R474.00	
H05	CUBIC BEECHWOOD			R434.00	
H06	CUBIC PRO CHAIR			R479.00	
H07	BOLERO CHAIR	BLACK & BEECHWOOD		R394.00	
H08	TRENDY CHAIR – GREEN			R395.00	
H08	TRENDY CHAIR – PURPLE			R395.00	
H09	ARMENT CHAIR – BLUE			R285.00	
H09	ARMENT CHAIR – GREEN			R285.00	
H09	ARMENT CHAIR – RED			R285.00	
H09	ARMENT CHAIR – YELLOW			R285.00	
H10	DELI CHAIR	WHITE		R81.00	
H11	BLUE FIZZ CHAIR	LIGHT BLUE		R284.00	
H12	ALUMINIUM CHAIR	ALUMINIUM		R387.00	
H13	KALAHARI CHAIR	DARK GREEN		R166.00	
H14	VISITORS CHAIR	BLACK & RED		R406.00	
H15	EXECUTIVE CHAIR	BLACK & BLUE		R406.00	
H16	MARLIN ARMCHAIR – BLACK			R285.00	
H16	MARLIN ARMCHAIR – BLUE			R285.00	
H16	MARLIN ARMCHAIR – BURGANDY			R285.00	
H19	ROUND BARSTOOL	BLACK & SILVER		R221.00	
H20	KATIE BARSTOOL	BLACK		R263.00	
H21	BLACK CHROME BARSTOOL			R345.00	
H22	COCKTAIL BARSTOOL			R285.00	
H23	LAURA BARSTOOL			R394.00	
H24	LONG JOHN SILVER BARSTOOL	RED & SILVER		R492.00	
H25	CUBIC BEECHWOOD BARSTOOL	BLACK & BEECHWOOD		R401.00	
H26	CUBIC SILVER BARSTOOL	SILVER & BLACK/WHITE		R394.00	
H27	ALUMINIUM BARSTOOL	SILVER		R392.00	
H28	SOLAR BARSTOOL – BLACK			R268.00	
H28	SOLAR BARSTOOL – RED			R268.00	
H28	SOLAR BARSTOOL – SILVER			R268.00	
H29	SELINA BARSTOOL	BLUE		R285.00	
H30	HIGH BACK CHROME & LEATHER BARSTOOL	BLACK		R387.00	
H34	CHROME BISTRO TABLE	SILVER		R885.00	
H35	RONDO COCKTAIL			R602.00	
H36	BEECHWOOD BISTRO TABLE (TUBULAR)	H 1070mm D 680mm		R748.00	
H37	BEECHWOOD CAFÉ TABLE	H 750mm D 900mm		R518.00	
H38	BEECHWOOD CAFÉ TABLE (TUBULAR)	H 750mm D 900mm		R518.00	
H39	BEECHWOOD TABLE ON CHROME LEGS	H 750mm D 900mm		R474.00	
H40	RONDO CAFÉ TABLE	H 710mm D 900mm		R600.00	
H41	CHROME CAFÉ TABLE	H 750mm D 560mm		R599.00	
H42	ROUND TABLE ON MILAN BASE	WHITE, H 750mm D 900mm		R272.00	
H43	SQUARE TABLE ON MILAN BASE	WHITE, H 750mm W 800mm		R272.00	
H44	ROUND WOODEN FOLDING TABLE			R285.00	
H45	SQUARE COFFEE TABLE	BLACK & WHITE, H 400mm W 610mm		R179.00	
H46	CHROME & GLASS COFFEE TABLE	H 450mm W 700mm D 500mm		R464.00	
H51	C'EST LA VIE CHAIR	NAARTJIE		R522.00	
H52	TRISTAN TUB CHAIR	DARK BLUE		R680.00	
H53	TUB CHAIR	BLACK		R446.00	
H54	LAYLA CHAIR – BLUE			R1 157.00	
H54	LAYLA CHAIR – RED			R1 157.00	
H55	LENNY SEATER- SINGLE	BLACK		R1 278.00	
H55	LENNY SEATER- DOUBLE	BLACK		R1 656.00	
H57	KOMODO SINGLE SEATER	BLACK & RED		R1 739.00	
H58	KOMODO DOUBLE SEATER	BLACK & RED		R1 897.00	
H59A	LOUNGE SUITE, 1 SEATER	BLACK; L 950mm D 750mm		R646.00	
H59B	LOUNGE SUITE, 2 SEATER	BLACK; L 1400mm D 750mm		R1 293.00	
H59C	LOUNGE SUITE, 3 SEATER	BLACK; L 1830mm D 650mm		R1 512.00	
H63	MAXIMA BAR COUNTER	SILVER & BLACK		R1 364.00	
H64	OCTANORM BAR COUNTER	WHITE; H 900mm W 1010mm D 500mm		R623.00	
H65	ENARA BROCHURE HOLDER			R568.00	
H66	BELE BROCHURE HOLDER			R568.00	
H67	BROCHURE HOLDER			R360.00	
H68	ZIG-ZAG BROCHURE HOLDER	BLACK		R518.00	

H69	COAT RACK	SILVER; H 1700mm		R189.00	
H70	UPRIGHT DISPLAY PANEL	WHITE PANEL; H 2000mm W 1000mm		R362.00	
H71	CLOTHES RAIL	SILVER; H 1500mm		R214.00	
H72	ROPE BARRIER	PER 1 METRE UNIT		R248.00	
H73	WATERCOOLER WITH 20L WATER			R1 125.00	
H74	HEXAGONAL DISPLAY PLINTH	WHITE; H 300mm D 500mm		R157.00	
H75	PEDESTAL PLINTH	H 500mm W 500mm D 500mm		R354.00	
H76	PEDESTAL PLINTH	H 1000mm W 500mm D 500mm		R387.00	
H77	SML WASTE BIN	BLUE		R34.00	
H78	LARGE WASTE BIN	GREY		R137.00	
H79	STANDING ASHTRAY/WASTE BIN	WHITE		R118.00	
H80	STAINLESS STEEL ASHTRAY & WASTE BIN	PERFORATED		R196.00	
H81	STAINLESS STEEL WASTE BIN	PERFORATED		R90.00	
H82	LARGE REFRIGERATOR	H 1145mm W 585mm D 595mm		R1 777.00	
H83	SMALL REFRIGERATOR	H 840mm W 520mm D 480mm		R1 270.00	
H84	NEWLINE CUPBOARD	H 900mm W 1010mm D 520mm		R657.00	
H85	OCTONORM CUPBOARD	H 900mm W 1030mm D 530mm		R593.00	
H86	NEWLINE GLASS TOP COUNTER	H 900mm W 1010mm D 500mm		R908.00	
H87	OCTONORM GLASS TOP COUNTER	H 900mm W 1030mm D 530mm		R731.00	
H88	NEWLINE SHOWCASE, LARGE	H 1980mm W 1010mm D 500mm		R1 631.00	
H89	OCTONORM SHOWCASE, LARGE	H 2000mm W 1030mm D 530mm		R1 631.00	
H90	NEWLINE SHOWCASE, SMALL	H 1980mm W 500mm D 500mm		R1 226.00	
H91	OCTONORM SHOWCASE, SMALL	H 2000mm W 530mm D 530mm		R1 270.00	
H92	STANDING SHELF	H 1360mm W 990mm D 495mm		R657.00	
H93	OFFICE DESK	H 665mm W 1505mm D 805mm		R650.00	
H115	TRESTLE TABLE	H 750mm W 1800mm D 750mm		R263.00	
	FULL LENGTH TABLE CLOTH	WHITE or BLACK		R196.00	
	FLAT SHELVES TO WALLING	W 1000mm D 300mm; MAX 25KG PER SHELF		R143.00	
	PLASMA BRACKET	FOR SCREENS =/ < 42"		R143.00	
	LOCK FOR CUPBOARDS & COUNTERS			R15.00	
	WIRE MESH GRID			R232.00	
				TOTAL EX VAT:	

PLEASE NOTE THAT PRICES EXCLUDE 14% V.A.T. (SA RESIDENTS ONLY)

Company Name: _____

Stand Number/s: _____

PAYMENT:

- Payment is required in full, before delivery will take place.
- Payment can be done up to two months prior to the exhibition, should you so desire.
- Once you have placed your order and completed the client information form and signed quote and paid in full, Oasys Exhibitions will arrange and forward you a tax invoice
- Payment can be done via credit card, bank transfer, cash or bank guaranteed cheque.
- Our bank account details are as follows:

Bank: Standard Bank - Southdale
Account Name: Oasys Innovations (Pty) Ltd t/a Oasys Exhibitions CT
Account Number: 000002787504
Branch Code: 006405
Swift: SBZAZJ

Interest on all overdue accounts will be levied at the rate of 2% above the Prime Overdraft Lending Rate of Standard Bank.

CONDITIONS OF HIRE & SUPPLY:

16. Orders subject to stock availability.
17. Items hired, remain the property of Oasys Exhibitions (Pty) Ltd.
18. NO GOODS WILL BE DELIVERED, UNLESS PAID FOR IN FULL WITH ORDER.
19. Late orders received after the cut off time will be subject to a surcharge of 50%.
20. Goods damaged, will be charged to the relevant exhibitor.

PLEASE KEEP A COPY FOR YOUR RECORDS

PLANT HIRE:



Company Name: _____

Stand Number/s: _____

Contact Person: _____

Postal Address: _____

Telephone Number: _____ Fax Number: _____

Email Address: _____

VAT# (SA Residents): _____

DEADLINE DATE: 28 April 2010

Enquiries: Beulah Henning

beulah@oasysexpo.com

Cell +27 (0) 83 215 8700

Please return forms to:

Tel: +27 (0)21 526 3200

Fax: +27 (0)21 552 1841

Services: services@oasysexpo.com

SEE OUR WEBSITE FOR IMAGES OF THE ITEMS: www.oasysexhibitions.co.za

OASYS EXHIBITIONS – PRO FORMA INVOICE

VAT REGISTRATION NO: 4610214399

A. INDOOR PLANTS - Standard Availability – Bushy Bamboo Palms, Kentia Palms, Ficus Benjamins (Green/White)

Pot Size	Description	Price
30cm Plastic	White Planter with Small Plant ± 0,8m	R 158.00
35cm Plastic	White Planter with Medium Plant ± 1,4m	R 173.00
43cm Plastic	White Planter with Large Plant ± 2m tall	R 187.00
49cm	Genuine Terracotta Planters with Large Plant	R 397.00
32cm	Mixed desk bowl	R 152.00
90cm x 20cm	Trough with greenery or colour	R 296.00
40cm	Stainless Steel Planters with Med/Large Plant	R 411.00
49cm	Genuine Ceramic Planters with Plant (White, Black, Burgundy, Persian Blue)	R 397.00

B. OUTDOOR PLANTS

Pot Size	Description	Price
35cm	Standard Eugenias – Topiary/Lollipop	R 187.00
35cm	Eugenias - Bushy +/- 1.6m	R 187.00
35cm	Roebelenii Palms +/- 0.8m	R 187.00
43cm	Cordylines +/- 1.8m	R 187.00
70cm	Outdoor Terracotta Lollipops	R 556.00
70cm	Outdoor Terracotta Cordylines	R 556.00
70cm	Outdoor Terracotta Conifers	R 556.00
70cm	Outdoor Terracotta Roebelenii	R 556.00
43cm	Striltzia +/- 1.8m	R 187.00

PLEASE NOTE THAT PRICES EXCLUDE V.A.T.

PAYMENT:

- Payment is required in full, before delivery will take place.
- Payment can be done up to two months prior to the exhibition, should you so desire.
- Once you have placed your order and completed the client information form and signed quote and paid in full, Oasys Exhibitions will arrange and forward you a tax invoice
- Payment can be done via credit card, bank transfer, cash or bank guaranteed cheque.
- Our bank account details are as follows:

Bank: Standard Bank - Southdale
 Account Name: Oasys Innovations (Pty) Ltd t/a Oasys Exhibitions CT
 Account Number: 0000002787504
 Branch Code: 006405
 Swift: SBZAJJ

Interest on all overdue accounts will be levied at the rate of 2% above the Prime Overdraft Lending Rate of Standard Bank.

CONDITIONS OF HIRE & SUPPLY:

21. Orders subject to stock availability.
22. Items hired, remain the property of Oasys Exhibitions (Pty) Ltd.
23. NO GOODS WILL BE DELIVERED, UNLESS PAID FOR IN FULL WITH ORDER.
24. **Late orders received after the cut off time will be subject to a surcharge of 50%.**
25. Goods damaged, will be charged to the relevant exhibitor.

PLEASE KEEP A COPY FOR YOUR RECORDS



EXHIBITION PROSPECTUS IEEE ICC 2010